



## IMPORTANT!

- Please read ParentCONNECTxp FAQ's **before** creating an account.
- If you already have an active account, **do not** register again!
- For technical and password issues contact the CFBISD Service Desk.  
*Telephone: 972.968.4357      Email: helpdesk@cfbisd.edu*
- To make changes to student demographic information, contact the school office.

## ParentCONNECTxp FAQ's

### Q: What is ParentCONNECTxp?

**A:** ParentCONNECTxp is a convenient home-to-school collaboration tool that allows parents/guardians of CFBISD students to keep track of their children's academic progress online via an easy-to-use web site. As a parent you will be able to view general student information as well as your student's class schedule, attendance, assignments, grades, discipline and health information. Parents may also elect to have alert messages sent via email to inform the parent of an issue regarding attendance, assignments or grades needing immediate attention. To maintain the integrity of student data, the ParentCONNECTxp application is a "read-only" system.

### Q: What is the minimum computer requirement needed to use ParentCONNECTxp?

**A:** You will need an Internet Provider. The system works best on the following internet browsers: Internet Explorer 5.0 or greater, AOL 5.0 or greater, or Netscape 4.7 or greater. ParentCONNECTxp will work with PC and MAC.

### Q: Who is eligible to use ParentCONNECTxp?

**A:** All parents/guardians who have legal rights to view their children's school records. Students are NOT allowed to register for access to this site.

### Q: Can more than one parent/guardian have access to a child's record?

**A:** Yes, with the same login. CFBISD allows one User ID and Password per household. Parents must have legal rights to view their child's school records. Legal parents/guardians not living in the same household will be allowed a separate User ID and Password providing each is listed in the Parent atom of the student information system.

### Q: I do not live in the same household as my child, can I still gain access to my child's information on ParentCONNECTxp?

**A:** Yes, as long as you are listed in the Parent atom of the student information system. Before being added to the system, you will be asked to provide proof that you have legal rights to view the child's educational records.

### Q: Can I access ParentCONNECTxp from any computer?

**A:** Yes. All you need is Internet access to view the ParentCONNECTxp website.

**Q: What if I do not have a computer in my home?**

**A:** You can use any computer with Internet access to view the ParentCONNECTxp website. Computers at the public library and your child’s school have internet access.

**Q: What do I do if I feel that the ParentCONNECTxp information is not updating?**

**A:** Click on the yellow "Home" button which is located on the right side of the ParentCONNECTxp banner. Make a note of the "last updated" date listed at the top of the page. If this date is several days behind the current date, there is a possibility that the information you are viewing may not be accurate. Please contact the CFBISD Service Desk.

**Q: What do I do if I lose my password?**

**A:** Contact the CFBISD Service Desk. You will be asked to provide your UserID. You will be notified when the password will be available for pickup at your child’s school. You will be required to show a photo ID to get the password.

**\*\* Please note: NO passwords will be given over the phone. \*\***

**Q: What do I do if I get "locked" out of my ParentCONNECTxp account?**

**A:** As a security measure, if you have three failed attempts entering your User ID and Password the system will prevent you from accessing your account. This protects you from having someone “hack” into your account. The system will automatically reset itself within 60 minutes. There is NO need to contact the CFBISD Service Desk. If you try logging in after the safety timeout, and you are still unsuccessful you will need to treat this as a lost password and follow the procedure for lost passwords.

**Q: How do I register for ParentCONNECTxp?**

**Step #1:**

- Open your browser
- Type www.cfbisd.edu--select the appropriate feeder system\*
- Click "Register" and click “Yes” on the Security Alert

**IMPORTANT NOTE**

If you have children who attend schools in different feeder systems, you will need to register in **each** feeder system for the child/children in that feeder system.

Feeder systems are listed on page 4.

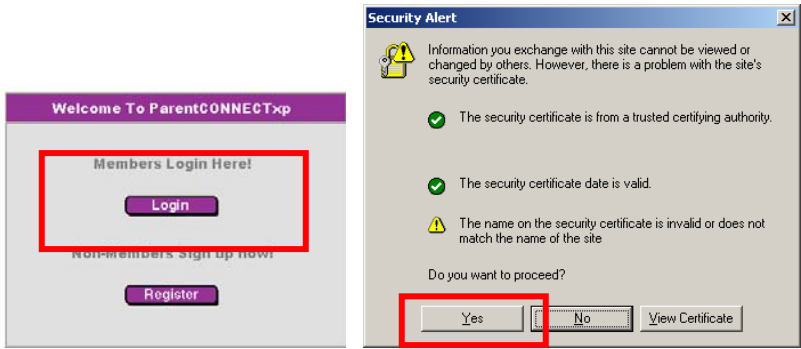

- Fill out both Parent Information & Student Information sections completely. **It is important to enter your student’s information in the same format as the examples that are given. The email address must be populated in order to receive “alert notifications”.**



## **Campus Feeder Systems\***

### **Ranchview Feeder System**

Ranchview High School  
Mary Grimes Education Center  
Bush Middle School  
Freeman Elementary  
Landry Elementary  
Las Colinas Elementary  
Riverchase Elementary

### **Creekview Feeder System**

Creekview High School  
Blalack Middle School  
Long Middle School  
Davis Elementary  
Furneaux Elementary  
Kent Elementary  
Rainwater Elementary  
Rosemeade Elementary  
Sheffield Intermediate  
Sheffield Primary  
Thompson Elementary

### **Newman Smith Feeder System**

Newman Smith High School  
Perry Middle School  
Polk Middle School  
Blanton Elementary  
Carrollton Elementary  
Country Place Elementary  
Good Elementary  
McCoy Elementary  
McKamy Elementary  
McWhorter Elementary

### **R L Turner Feeder System**

R L Turner High School  
Field Middle School  
Blair Intermediate  
Central Elementary  
Farmers Branch Elementary  
McLaughlin Elementary  
Montgomery Primary  
Stark Elementary